

PROJECT

## LANDED *blur*

TYPE

INVITED COMPETITION

WINNER - ALTERNATE FOR CONSTRUCTION

LOCATION

PHILBROOK MUSEUM

TULSA, OK

DATE

2005

Situated on the grounds of the Philbrook Museum of Art, two pavilions sit as smudges in the landscape. An horizontal 18'x9'x9' mirror box and a vertical 9'x9'x18' branch box stand in dialogue with one another and the surrounding landscape. Evaporating into the natural surroundings, the lattice boxes become viewing chambers for engaging, focusing, and re-experiencing the surrounding landscape. Made of layered 2"x2" pine structure, the frame folds and deforms to form both furniture and oculus. Each reflects and dissolves their exterior to enigmatically meld with the surrounding landscape, while their interiors become anthropomorphically scaled furniture landscapes each engaging a framed view. The horizontal box is cloaked in slightly canting standard closet mirrors: pre-cut and inexpensive. The undulating surface re-presents the surrounding landscape in a pixilated fractal blur. The branch box employs recycled branches trimmed from the grounds of the Philbrook Gardens. These natural entities group to form a dense thicket. The branch box houses a single chair and a sunken corten impluvium. An exaggerated conpluvium of dangling 2"x2"s creates a framed roof oculus composing the sky. The two figures reflect and compliment the landscape blurring the surroundings in their surface and framing it through their viewing mechanisms. They stand as silent composed figures: chambers for viewing and figures for engaging.



**BORDEN PARTNERSHIP**

1918 LAUDERDALE STREET  
HOUSTON, TEXAS 77030

[www.bordenpartnership.com](http://www.bordenpartnership.com)



PROJECT  
**LANDED blur**

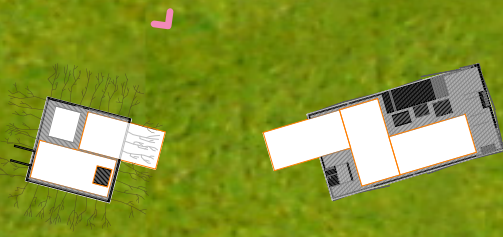

ELEVATED VIEW FROM RIDGE



**BORDEN PARTNERSHIP**  
1918 LAUDERDALE STREET  
HOUSTON, TEXAS 77030

[www.bordenpartnership.com](http://www.bordenpartnership.com)







PROJECT  
**LANDED *blur***

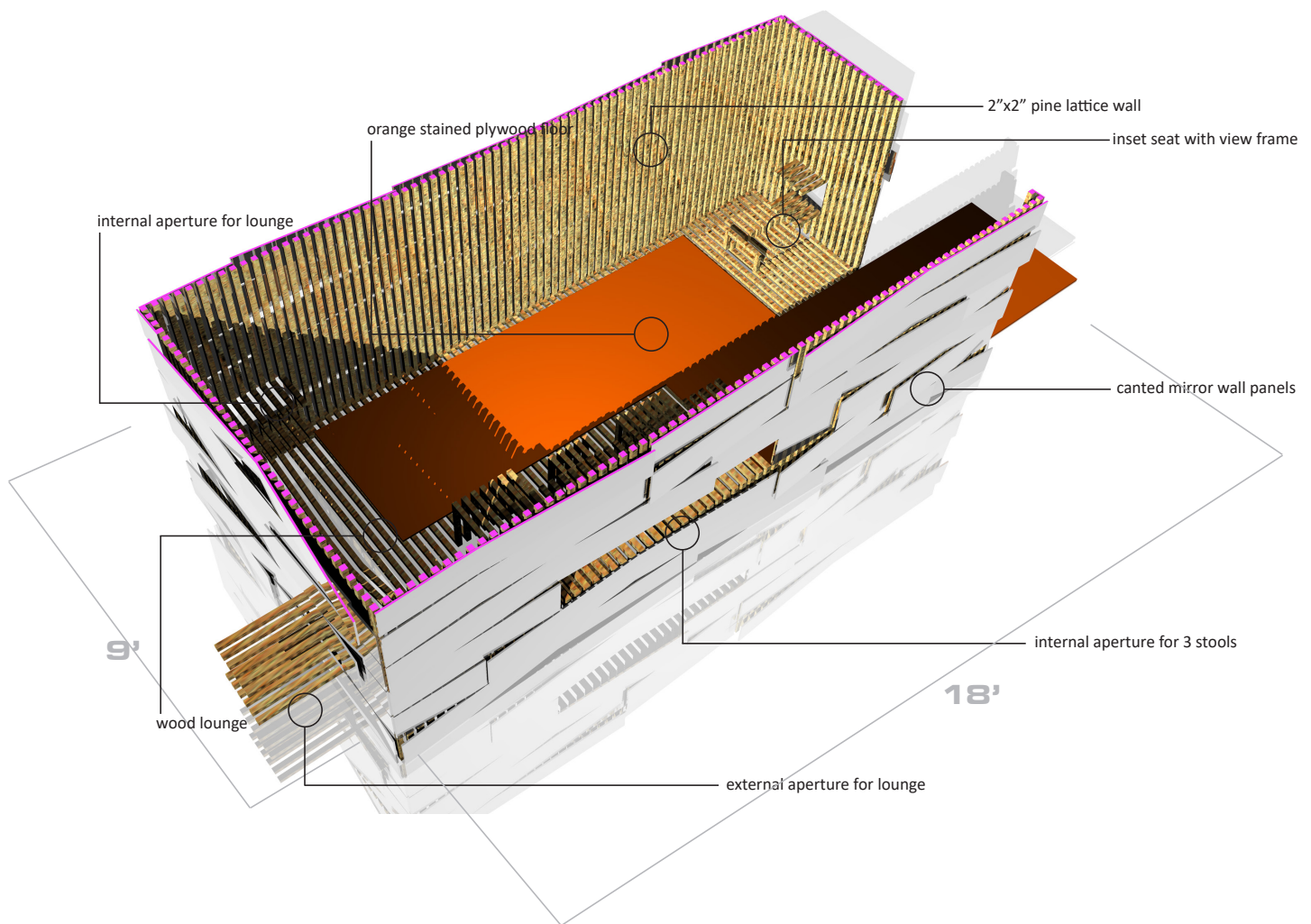

SECTIONAL PLAN



**BORDEN PARTNERSHIP**  
1918 LAUDERDALE STREET  
HOUSTON, TEXAS 77030

[www.bordenpartnership.com](http://www.bordenpartnership.com)



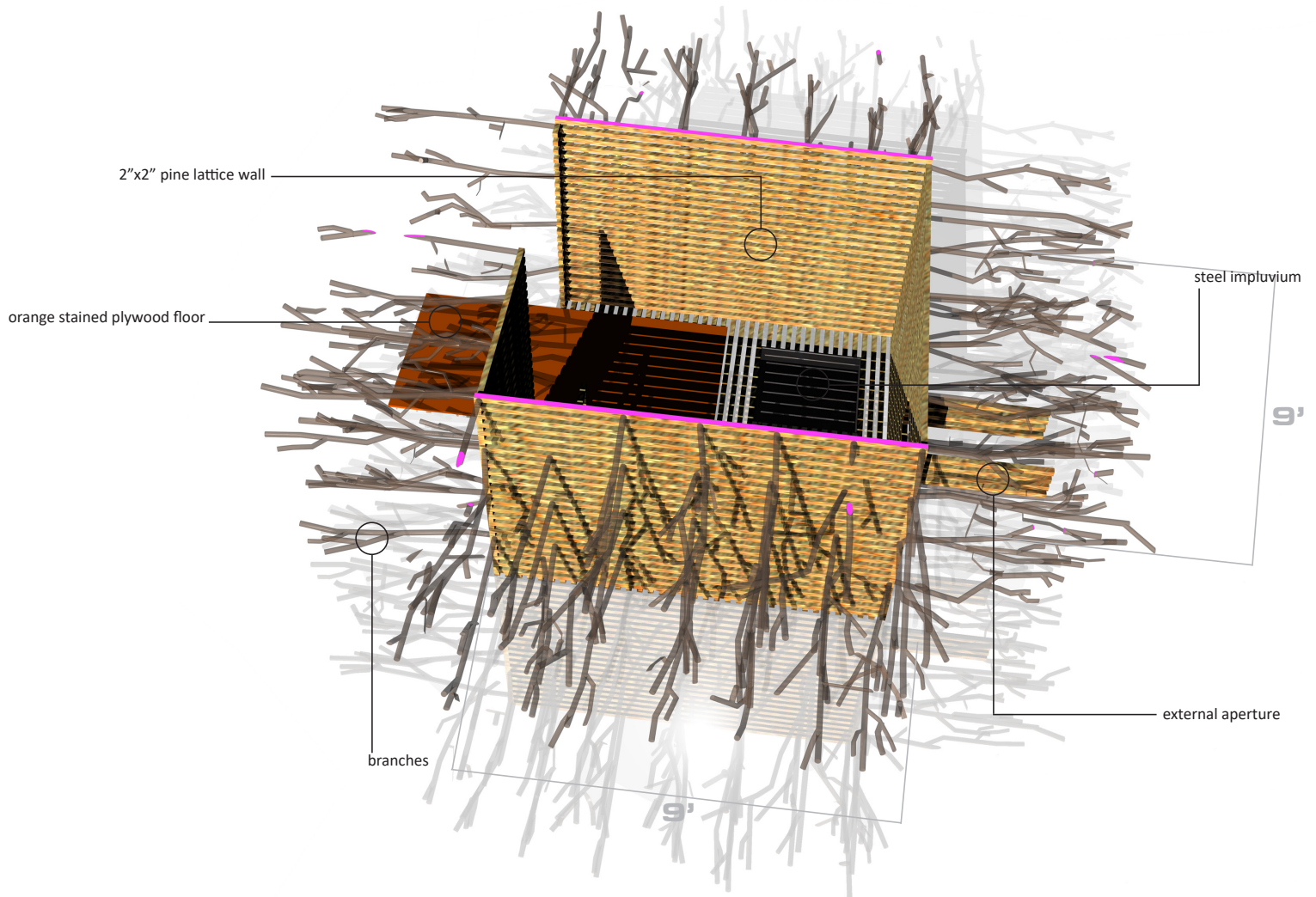



PROJECT

# LANDED blur



MIRROR BOX - UNDULATING FRACTAL SURFACE

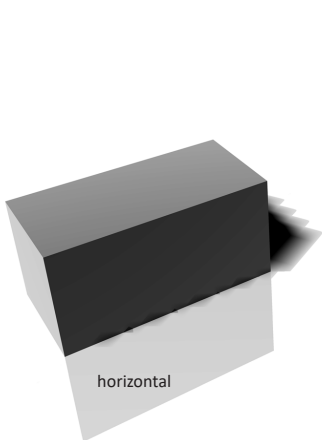
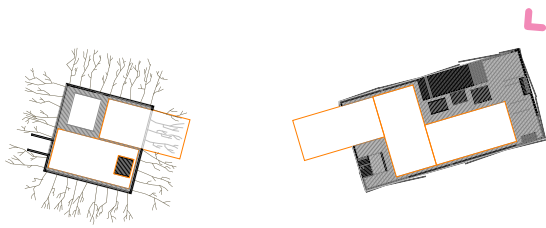

horizontal

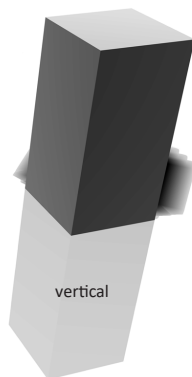

vertical

DIMENSIONAL VOLUMES

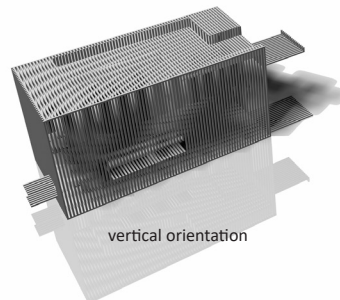

vertical orientation

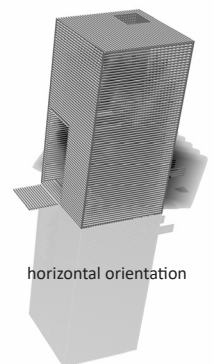

horizontal orientation

2"X2" PINE LATTICE FRAMES



**BORDEN PARTNERSHIP**

1918 LAUDERDALE STREET  
HOUSTON, TEXAS 77030

[www.bordenpartnership.com](http://www.bordenpartnership.com)



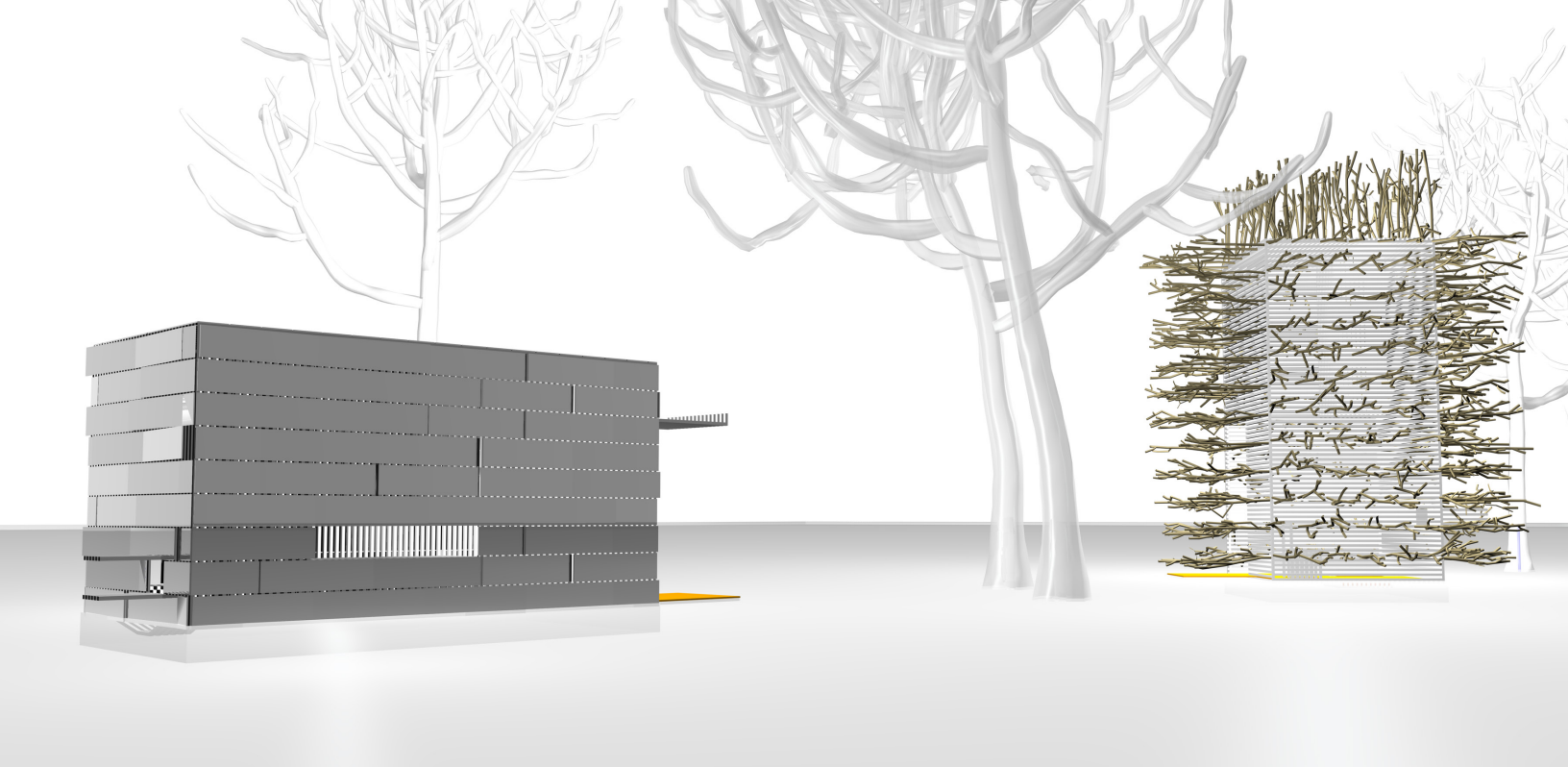

MIRROR BOX + BRANCH BOX: LANDSCAPE BLURS

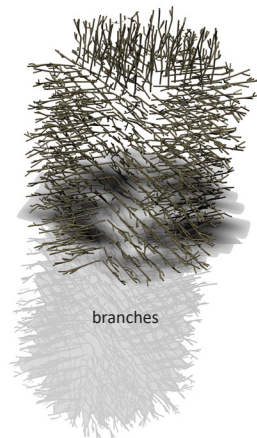
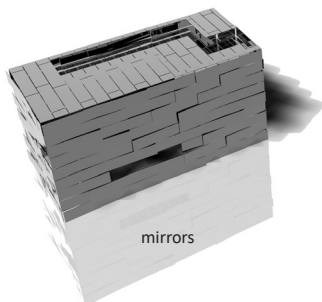
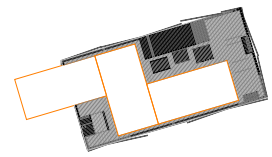
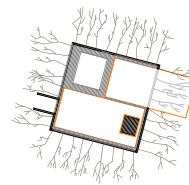

BLURRED SKINS

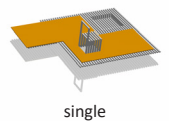
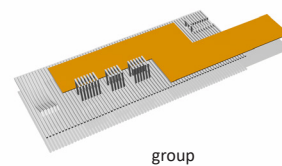

SURFACE + CIRCULATION





– 2"x2" lattice

— oculus

— chair

- plywood floor

**BORDEN PARTNERSHIP**

1918 LAUDERDALE STREET  
HOUSTON, TEXAS 77030



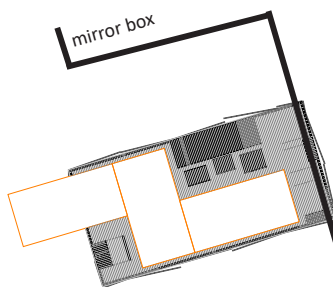
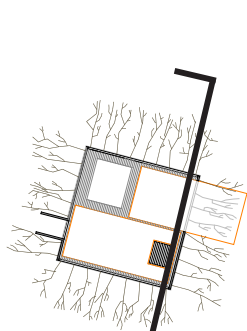

dropped ceiling

sunken seating

plywood floor

view aperture

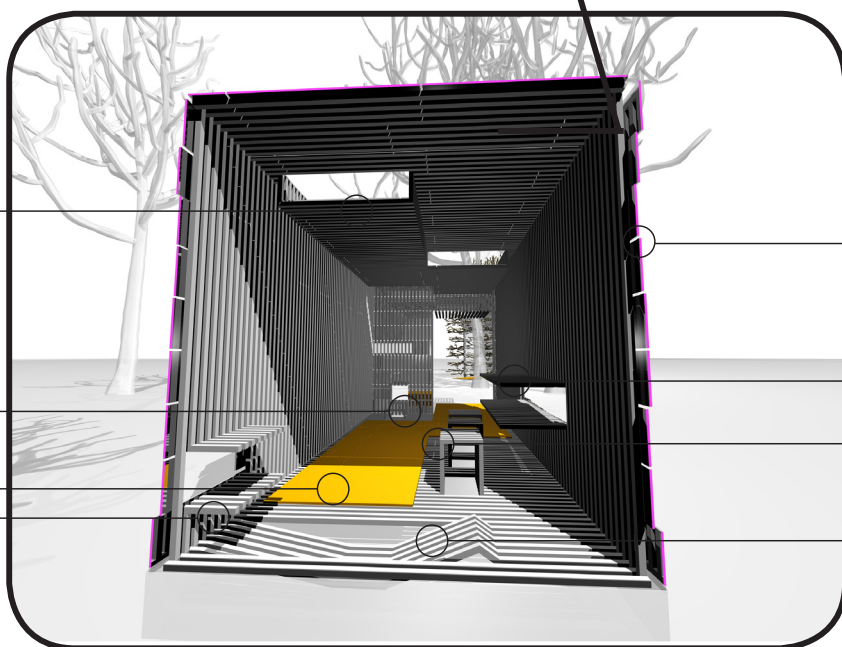

mirror cladding

view aperture

3 stools

lounge



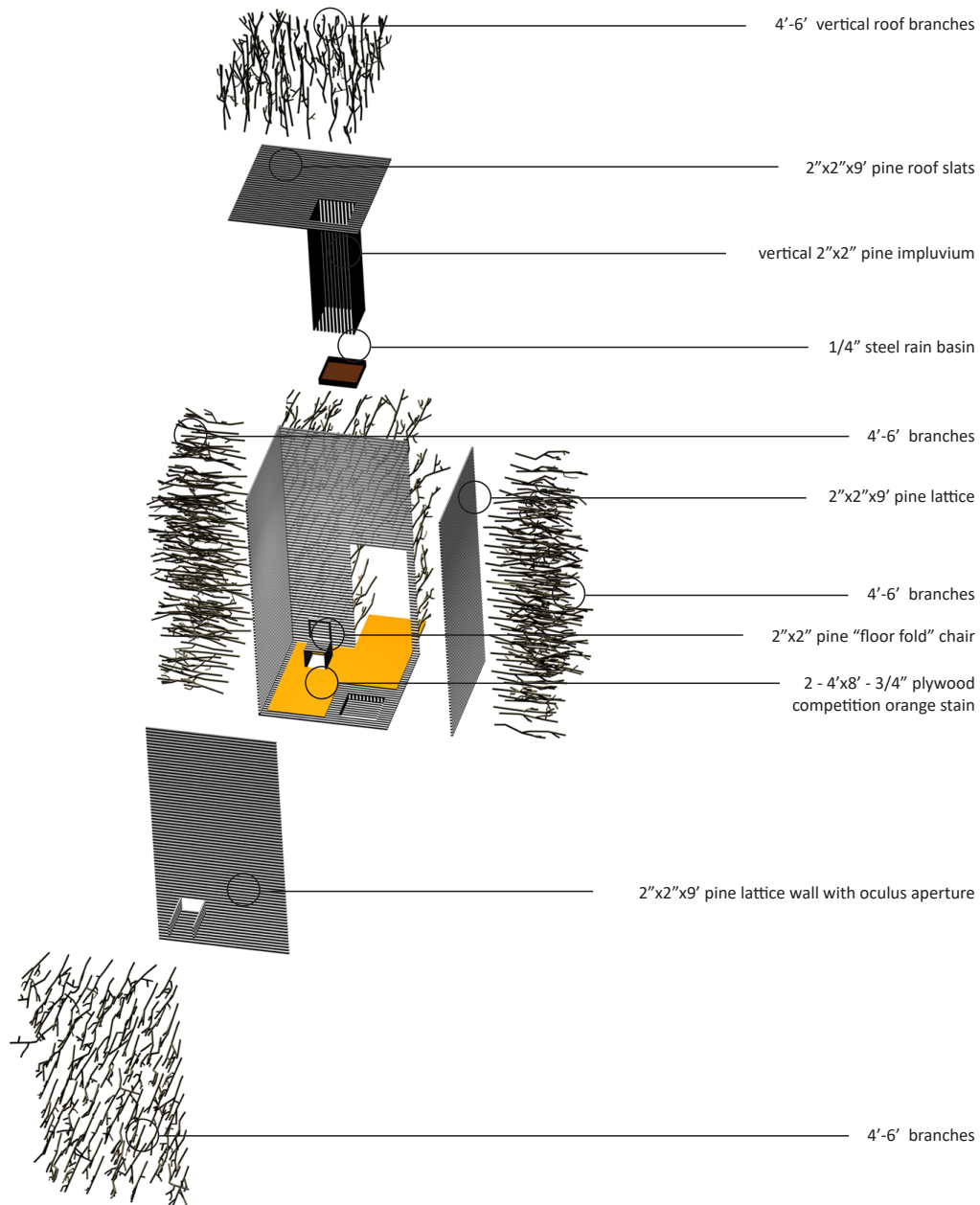

Richard Serra



Donald Judd



James Turrell



Eva Hesse

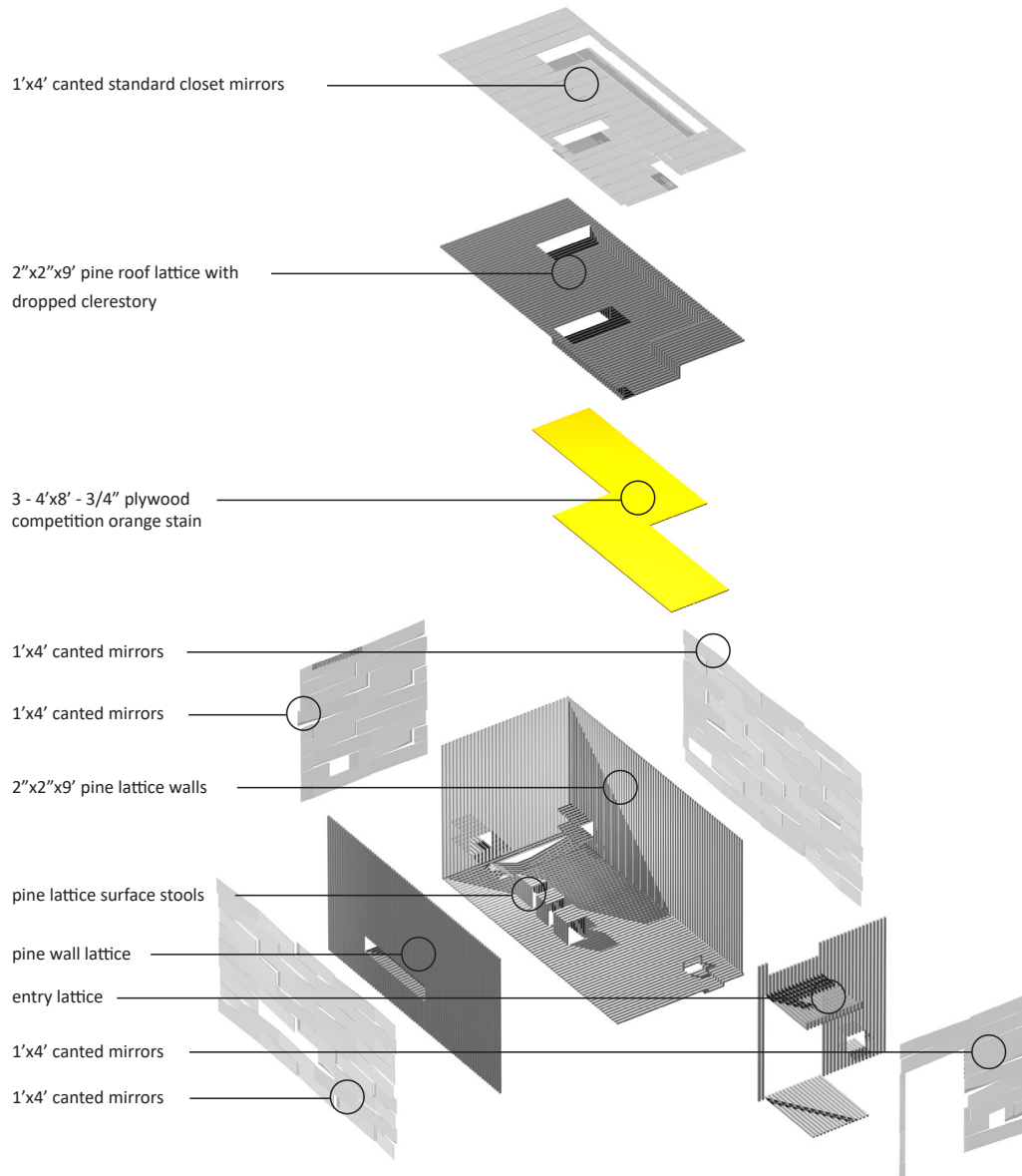

mirror room



Carl Andre

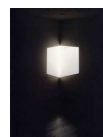

James Turrell



Anish Kapoor